

Forged Carbon Steel Plugs

3000#

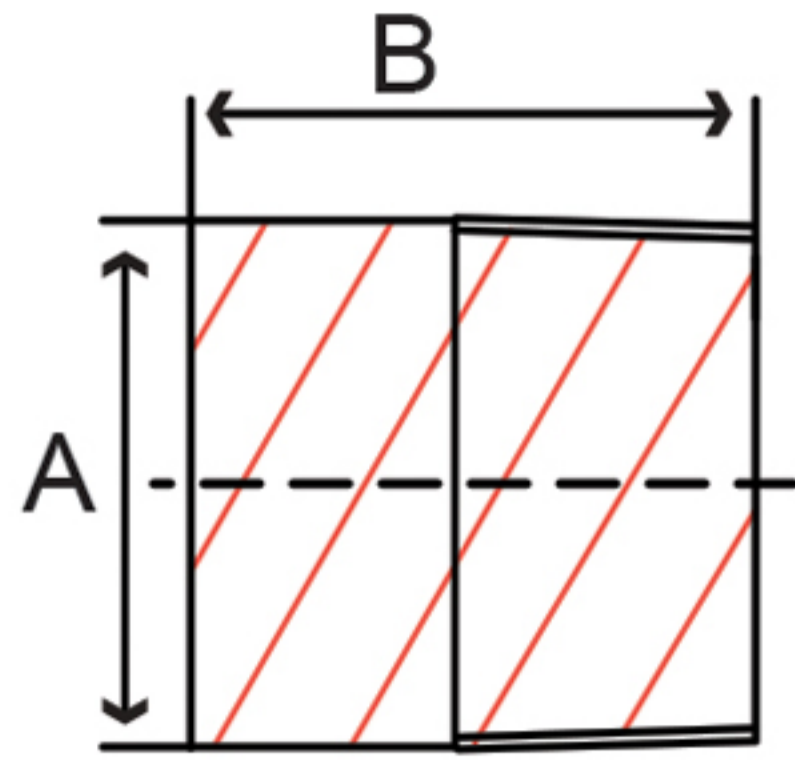

Fig. 42RP3 – Round Head Plug

Size IN	Part Number	A IN	B IN	Master	Weight LB
1/2	42RP3004	0.84	1.75	150	0.2
3/4	42RP3006	1.06	1.75	100	0.4
1	42RP3010	1.31	2.00	80	0.7
1-1/4	42RP3012	1.69	2.00	50	1.2
1-1/2	42RP3014	1.91	2.00	30	1.7
2	42RP3020	2.38	2.50	20	3.2

FORGED